

# SD to CardBus PC Card High Speed Reader/Adapter SDCBA-C01



**C-Ming Technology** proudly presents you a perfect solution for accessing the SD (Secure Digital Card) via 32-bit CardBus interface with a higher speed.

This adapter supports converting SD card to Type II CardBus PC Card. A Push-Push socket is equipped for easy insertion/extraction of supported cards.

SDCBA-C01 is also compliant with SDIO specification, which allows you to use SDIO card with all kinds of applications on your computer.

SDCBA-C01 is a very convenient and high speed SD card reader for any computer equipped with 32-bit CardBus socket. If you are tired of using the card reader with a slow speed, you should absolutely try SDCBA-C01; just contact **C-Ming Technology** now!

## Features

- + Compliant with 32-bit CardBus Type II PC Card interface (JEIDA 4.2). Maximum frequency reaches 33MHz.
- + Compliant with SD Specification 3.0 (SDXC).
- + Compliant with SDIO Specification 1.1.
- + Compliant with SD Host Controller Standard Specification 1.0.
- + Present as a "SD Slot on PC" under Windows.
- + Low power consumption, 3.3V single power operation.
- + Supports SD Specification 2.0 (SD / SDHC).
- + Supports all kinds of SDIO Card Applications.
- + Compliant with MultiMediaCard Specification 4.1.
- + Push-Push card slot for easy insertion/extraction of card.

## Specifications

- + Input Socket SDXC / SDHC / SD (SD Specification 3.0)  
SDIO (SDIO Specification 1.1)  
MMC (MMC Specification 4.1)
- + Output Interface 32-bit CardBus Type II PC Card
- + Supporting Card SDHC 4GB~  
SD 8MB~2GB  
miniSD 8MB~2GB (Adapter Required)  
microSDHC 4GB~ (Adapter Required)  
microSD 8MB~2GB (Adapter Required)  
MMC / MMC Plus All Capacities  
RS-MMC / MMC Mobile All Capacities
- + Supporting OS Windows XP / VISTA / 7
- + Safety Approval CE / FCC / BSMI
- + Dimensions 85.0 mm(L)\* 54.0 mm(W)\* 5.0 mm(H)

## Application Diagram

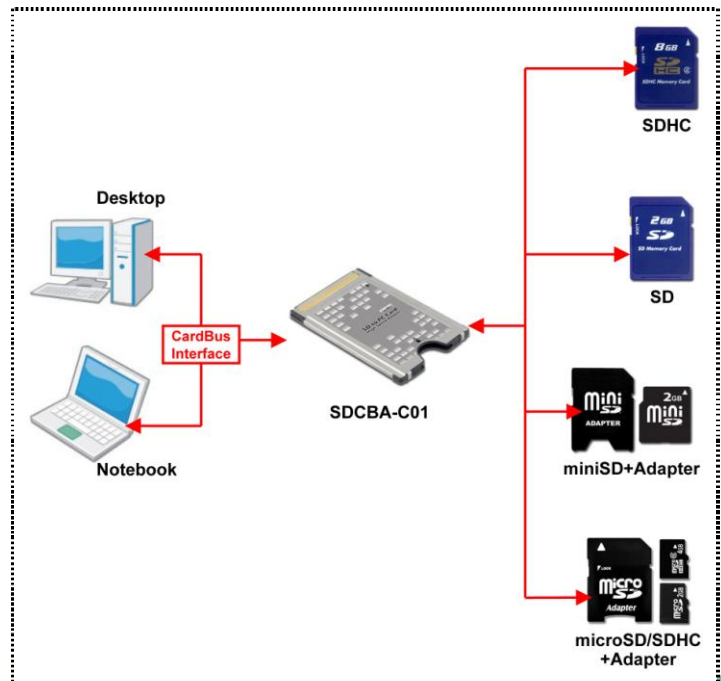

**C-MING TECHNOLOGY CO., LTD.**

2F., No.104, Minzu Rd., Sindian City,  
Taipei County 231, Taiwan (R.O.C.)

TEL: 886-2-22181670

FAX: 886-2-22181570

www.cm-tech.com.tw